



INFINITY

- 6" Galvanised Chassis
- 100L Fresh Water
- Torsion Suspension with shocks
- Washing Machine
- Desert Master A-Frame
- 200W Solar
- Composite Construction
- 120AH AGM Battery



info@onthemovecaravans.com.au

www.onthemovecaravans.com.au

On The Move

CARAVANS

www.onthemovecaravans.com.au

INFINITY

Chassis

- | 6" galvanised box tube chassis
- | Desert Master A-Frame
- | Torsion suspension with Shocks
- | 50mm ball coupling
- | Stabiliser legs
- | Jockeywheel
- | Battery Box
- | Rear Bumper with Spare wheel
- | Street tyres 265/75 R16
- | 10" Electric Brakes (12" on single axle)
- | 500mm Side Protection

Construction

- | Timberless single piece roof
- | Timberless single piece side walls
- | 1 piece honeycomb floor

External

- | Door with Flyscreen
- | Flat double glazed RV Windows
- | Awning
- Picnic Table
- | Alloy fold out step
- | Entrance handle with light
- | Black aluminium hatches
- | Vented Skylight
- | Bathroom vent

Plumbing

- | Thermostatic valve
- | Instant continuous hot water
- | 100L Fresh water tank
- | Low Pressure water inlet
- | Gas regulator
- | Gas bottles x 2

Internal

- | Lightweight Plywood furniture
- | Soft close drawers and metal runners
- | Splashback
- | Doorside pocket and coat hooks
- | Door head protection
- | Leatherette upholstery
- | Queen memory foam mattress
- | Extendable ribbed bed frame

Electrical

- | 120AH AGM Battery
- | Projecta PM200 Control System
- | 100W Solar panels x 2
- | Reading Lights
- | Down Lights
- | Outdoor lights
- | Ensuite mirror with light
- | Smoke alarm

Appliances

- | Air Conditioner
- | 185L 12V Compressor Fridge
- | Microwave 20L
- | Gas/Electric cooktop
- | Washing Machine
- | Cassette Toilet
- | Rangehood
- | Flat Screen TV & Antenna

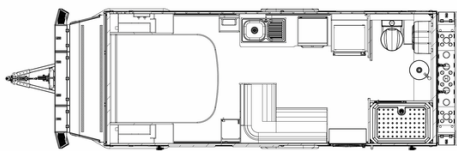

5.5

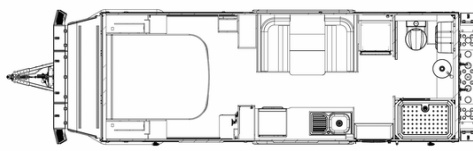

6.3

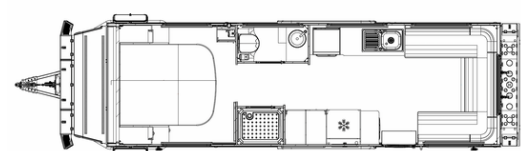

7.2

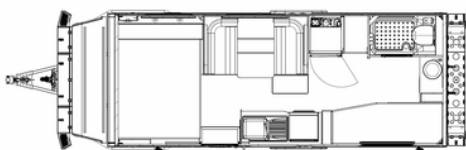

5.7F

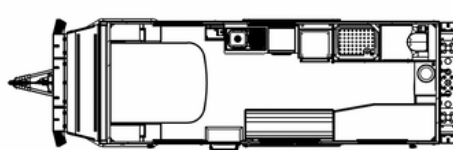

6.3F

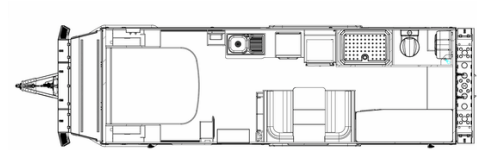

6.9F